

NOTES:

1. THIS PROJECT IS LOCATED ON ASSESSOR'S MAP 54.
2. TOPOGRAPHY TAKEN BY ELECTRONIC DATA COLLECTION/GPS METHOD PERFORMED BY THE STOUGHTON ENGINEERING DEPARTMENT.
3. COORDINATES SHOWN ARE BASED UPON THE MASSACHUSETTS STATE PLANE SYSTEM MAINLAND ZONE.
4. CAUTION IS GIVEN WHERE THE LOCATION AND/OR ELEVATION OF EXISTING UTILITIES AND STRUCTURES AS SHOWN ON THESE PLANS IS BASED ON RECORDS OF VARIOUS UTILITY COMPANIES AND WHERE POSSIBLE, MEASUREMENTS TAKEN IN THE FIELD. THIS INFORMATION IS NOT TO BE RELIED ON AS BEING EXACT OR COMPLETE. THE LOCATION OF ALL UNDERGROUND UTILITIES AND STRUCTURES SHALL BE VERIFIED IN THE FIELD PRIOR TO THE START OF CONSTRUCTION. CONTACT THE APPROPRIATE UTILITY COMPANY, ANY GOVERNING PERMITTING AUTHORITY, AND "DIG SAFE" AT LEAST 72 HOURS PRIOR TO ANY EXCAVATION WORK TO REQUEST EXACT FIELD LOCATION OF UTILITIES INTERFERING WITH THE PROPOSED CONSTRUCTION AND APPROPRIATE REMEDIAL ACTION TAKEN BEFORE PROCEEDING WITH THE WORK.
5. THE EXISTING TREE IN THE MULCH BED AT THE SOUTHERLY END OF THE EXISTING CENTER ISLAND IS TO BE RELOCATED AT THE DIRECTION OF THE FRIEND'S OF STOUGHTON CENTER'S BEAUTIFICATION COMMITTEE.
6. LIMIT OF WORK IS CURB TO CURB OR AS NOTED.
7. ALL EXISTING PAVEMENT MARKING WITHIN THE PROJECT LIMITS ARE TO BE MECHANICALLY REMOVED WHERE EXISTING MARKING DOES NOT COINCIDE WITH THE PROPOSED PAVEMENT MARKING.
8. PROPERTY LINE LOCATION WAS COMPILED FROM ASSESSOR'S MAP INFORMATION. IT IS PROVIDED AS A GENERAL INFORMATIONAL GUIDELINE ONLY, AND IS NOT EXACT. THE ENGINEERING DEPARTMENT IS NOT RESPONSIBLE FOR THE USE OF THIS PLAN FOR LOCATION PURPOSES RELATIVE TO THE PROPERTY LINE.

LEGEND

ABBREVIATION	DESCRIPTION
SWLL	SOLID WHITE LANE LINE
SYLL	SOLID YELLOW LANE LINE
DWLL	DASHED WHITE LANE LINE (2' SEGMENT WITH 2' GAP)
BWLL	BROKEN WHITE LANE LINE (10' SEGMENT WITH 30' GAP)
DYLL	DOUBLE YELLOW LANE LINE

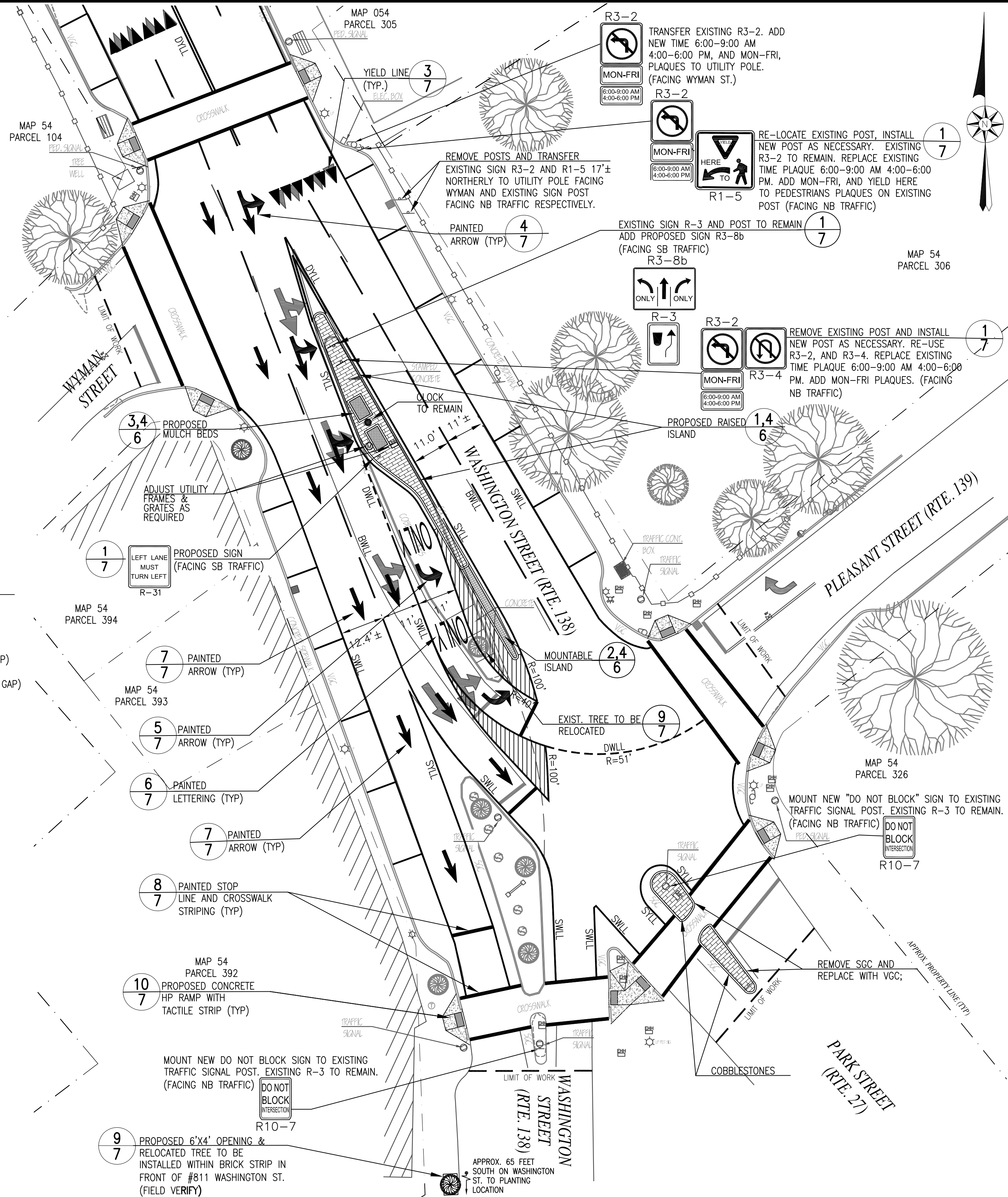

PLAN REVISIONS

NO.	REVISION DESCRIPTION	DATE
1		
2		
3		
4		
5		



TOWN OF STOUGHTON
ENGINEERING DEPARTMENT
10 PEARL STREET
STOUGHTON, MA 02072

TRAFFIC ISLAND & LANE MODIFICATIONS

TOWN SQUARE WASHINGTON STREET
MAP 54
STOUGHTON, MA

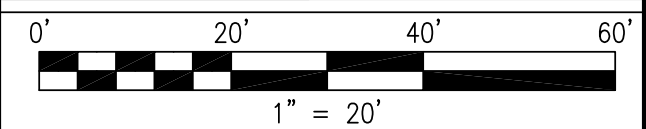

FIELD BY:	CAH/MCN
DRAWN BY:	CAH/MCN
CHECKED BY:	MJT/CAH
APPROVED BY:	MJT/CAH
DATE:	SEPTEMBER 8, 2016
JOB NUMBER:	15-006

PREPARED FOR:
TOWN OF STOUGHTON
BOARD OF SELECTMEN
10 PEARL STREET
STOUGHTON, MA 02072

RECORD OWNER:
TOWN OF STOUGHTON
10 PEARL ST.
STOUGHTON, MA 02072

PLAN REFERENCE:
TOWN CENTER IMPROVEMENTS
STOUGHTON CENTER
BAYSIDE ENGINEERING
MARCH, 2004

PROPOSED ISLAND LAYOUT & STRIPING PLAN (SOUTH)